



Load Links

Accurate and reliable tensile load monitoring for lifting applications.



Options



Wireless & Internal Antenna



Matched Telemetry Displays



Rent this item



Cabled with 49.2ft flying cable



Data Logging Software Available



ATEX version

Suitable for all industry sectors including marine, offshore and subsea.

Due to the robust, lightweight high tensile aluminium design these load links are ideal for mobile applications and available as either cabled or wireless with a range of options.

Displays & Portable Case

Rugged case design with foam compartments to firmly hold the load link, telemetry display, spare set of batteries. Can also accommodate connecting cable for wired units and matched set of shackles.

- Lockable case
- Plastic case available for 1Te - 85Te
- Custom transport case 100Te - 500Te



Load Cell Data Logging

LMS-LOG100 Advanced data logging software provides real time monitoring of up to 100 load cell devices simultaneously.

Remotely access your data quickly and easily from a computer, tablet & smart phone via web browser. Export data in standard JSON or CSV formats with customizable reporting to suit your needs.



Features

- Load link designs from 1Te to 500Te as standard other capabilities on request
- Designed to be rigged & operated with a Working Load Link (WLL) of the same capacity
- Safety factor of 5:1
- Accuracy <0.5% of applied load
- ATEX versions available for zones 0, 1, & 2
- Subsea variants available on request
- Every unit load tested and certified



DISTRIBUIDOR AUTORIZADO ESPAÑA

Tel. +34 91 683 03 00 - ventas@sercables.com



www.loadmonitoringsystems.com

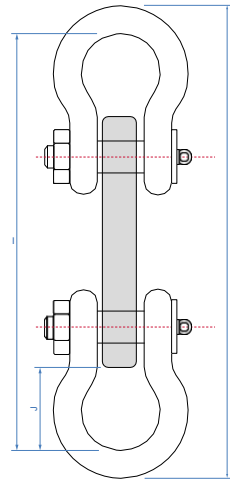
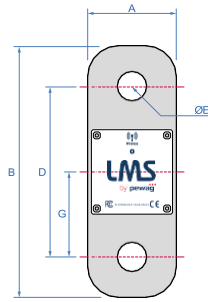

Load Link Dimensions mm																	
Capacity Tonne	1	3.25	4.75	6.5	13.5	17	25	35	55	85	100	150	200	250	300	400	500
A	52	60	60	84	84	93	127	137	163	198	236	272	331	353	398	490	540
B	151	183	183	238	292	302	332	386	466	518	610	695	769	829	937	1037	1137
C	31	31	31	32	45	50	60	70	75	104	105	136	150	175	190	198	198
D	117	133	133	162	182	182	206	226	286	310	350	395	419	469	517	547	607
ØE	12	20	23	27	40	43	55	61	75	86	100	118	135	145	158	180	190
G	58.5	66.5	66.5	81	91	91	103	113	143	155	175	197.5	209.5	234.5	258.5	273.5	303.5
Weight (kg)	0.35	0.65	0.65	1.35	2.3	3	5.7	8.25	16	23.45	36.05	59.5	89.5	123.5	167	251	311
Load Link & Shackle Dimensions mm																	
H	221	312	345	397	556	592	702	777	1006	1201	1435	1533	1815	1977	2183	2398	2588
I	201	280	307	353	486	516	612	677	876	1051	1245	1323	1575	1717	1903	2058	2228
J	25	48.5	62	57.5	97	107	140	145.5	205	266.5	317.5	314	403	444	483	510.5	545.5
Combined Weight (kg)	0.67	2.13	3.01	4.89	15.38	19.38	34.14	47.31	95.18	147.45	256.05	409.5	559.5	693.5	847	1371	1681
Kit Weight (kg)	2.5	6	6	5	6	6.7	9.5	12	23	30	47	74	106.15	140.15	183.65	267.65	327.65
Shackle Size / Type																	
Van Beest							G-4163					P-6036					
GN Rope							H9					H10					
Crosby							G2130 to G2140										

Specifications	
Overload Tested (Proof Load)	200% rated load (6.5te - 250te sizes) 150% rated load 300te and above
Minimum Breaking Load (MBL)	5Te to 400Te
	500Te
Dead Load Offset	+/- 0.1mV
Accuracy	< 0.5% of applied load
Repeatability	< +/- 0.1% of applied load
Hysteresis up to FS	Minimal
Operating temperature	-20°C to +70°C
Environmental Rating	IP67
Range	800 Meters (straight line uninterrupted view)
Transmit rate	900ms (standard)
Antenna (Wireless Version)	Internal
Radio (Wireless Version)	2.4 Ghz; worldwide licence free
Cabled Version Output Signals	Analogue signals 4-20mA in 2 or 3 wire output with 10-30VDC supply 0-5VDC or 0-10VDC 3-wire output with 10-30VDC supply Digital signals RS232 with a protocol of your choice with 5-20VDC supply RS485 with a protocol of your choice with 5-20VDC supply
Cable Version Connection Type	Load link with plug-in socket and 15m, 4-core screened PUR cable with matched plug-in connector fitted. Other types on request.
Battery Type / Lifespan	Load Cells
	Display
Calibration	12 months (calibration service available)
Warranty	12 months
Material Finish	Lightweight, high tensile grade aluminium, hard anodised for marine environments.
Traceability and Safety Compliance	BS EN ISO 7500-1:2004, Machinery directive 2006/42/EC (SI 2008/1597)
ATEX Options	
Zone 2	Standard options (wireless and cabled) - see datasheet
Zone 1	Standard options (wireless and cabled) - see datasheet
Zone 0	Stainless steel construction, cabled options – contact LMS for more details